



PIPE SUPPORT



Barb Clips

Ideal for horizontal support on refrigeration installations.



Channel



Rod



Surface

KEY FEATURES

- Fast fixing directly into a 10mm hole without the need for screws or plugs
- Unique lockable ratchet design
- Fits metric and imperial pipe

SPECIFICATIONS

Materials of construction	Nylon
Max. temp	70°C
Max. rec. distance per clip	1.2m

SIZING OPTIONS

Size	Part No. (Xtra)	Part No. (TNC)	Pack Qty
6mm (1/4")	-	TNC/WP/006/11MM	10
10mm (3/8")	-	TNC/WP/006-2/11MM	10
13mm (1/2")	-	TNC/WP/008/11MM	10
16mm (5/8")	-	TNC/WP/010/11MM	10
19mm (3/4")	-	TNC/WP/020/11MM	10
22mm (7/8")	B7006/10	TNC/WP/030/11MM	10
25mm (1")	-	TNC/WP/040/11MM	10
28mm (1 1/8")	B7008/10	TNC/WP/050/11MM	10
32mm (1 1/4")	B7009/10	TNC/WP/060/11MM	10
35mm (1 3/8")	B7010/10	TNC/WP/070/11MM	10
38mm (1 1/2")	-	TNC/WP/080/11MM	10
41mm (1 5/8")	-	TNC/WP/090/11MM	10
50mm (2")	-	TNC/WP/100/11MM	10
55mm (2 1/8")	-	TNC/WP/110/11MM	10
Wall anchor plug	-	TNC/WP/10mm	10
2 Pipe	B7300/5	TNC/11WP/FR-4	5

Approximate pipe sizes (allowing for 13mm insulation)

BARB CLIP 1 PIPE INSTALL

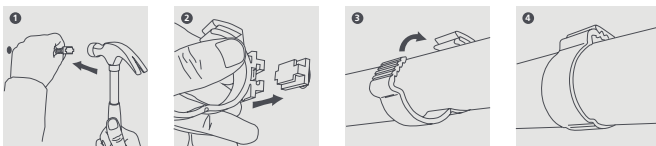

BARB CLIP 2 PIPE INSTALL

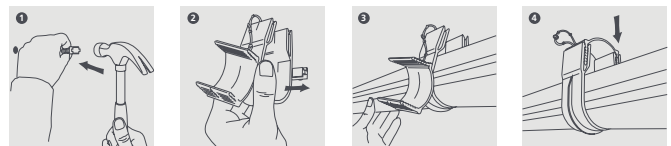

Information correct at time of going to press.

